



**TWO STAGE GAS HIGH EFFICIENCY
COUNTERFLOW / HORIZONTAL FURNACE SPECIFICATIONS**

MODEL NO.	CDX3-75N	CDX3-100N	CDX3-125N
FUEL	GAS NAT/LP	GAS NAT/LP	GAS NAT/LP
INPUT BTUH (HIGH FIRE / LOW FIRE)	75,000 / 56,250	100,000 / 75,000	125,000 / 93,750
OUTPUT BTUH¹	71,000 / 52,000	94,000 / 70,000	116,000 / 87,000
SEASONAL EFFICIENCY²	92.6%	92.6%	92.3%
LARGEST REC A/C³	3.5 T	4 T	5 T
NOMINAL TEMP RISE	65° / 60°	65° / 60°	65° / 60°
APPROX EFFECTIVE HEATING SURFACE	5950 SQ IN	6500 SQ IN	7025 SQ IN
APPROX SHIPPING WEIGHT	195 LBS	210 LBS	243 LBS
APPROVAL AGENCY	CSA	CSA	CSA
DIA OF FLUE (PVC)	2"	3"	3"
DIA OF COMBUSTION AIRINTAKE (PVC)	2"	3"	3"
QTY AND SIZE OF PERMANENT FILTERS	TWO 1" x 22" x 14"	TWO 1" x 22" x 14"	TWO 1" x 22" x 14"
ELECTRICAL RATING	115V 60HZ 1PH	115V 60HZ 1PH	115V 60HZ 1PH
MAX FUSE SIZE	15 AMP	15 AMP	20 AMP
ACCESSORY ITEMS			
COMBUSTIBLE FLOOR BASE	50DA-BASE	100CA-BASE	125CA-BASE
PROGRAMMABLE T-STAT STD/DELUXE	350164 / 350165	350164 / 350165	350164 / 350165
CONCENTRIC VENT KIT	AOPS7488	AOPS7489	AOPS7489
SIDEWALL VENT CAP	370191	370191	370191
NEUTRALIZER KIT	320095	320095	320095
CONDENSATE PUMP	350225	350225	350225
NAT. CONVERSION KIT	-	-	-
LP CONVERSION KIT	AOPS7682	AOPS7683	AOPS7419
FURNACE PARTS KIT	AOPS7504	AOPS7504	AOPS7504

¹ OUTPUT BTUH BASED ON ANNUAL FUEL UTILIZATION EFFICIENCY RATED BY MANUFACTURER.

² SEASONAL EFFICIENCY (ALSO CALLED AFUE - ANNUAL FUEL UTILIZATION EFFICIENCY) RATINGS ARE BASED ON TESTS FOLLOWING U.S. DEPARTMENT OF ENERGY TEST PROCEDURES.

³ TO PERMIT LARGEST RECOMMENDED AIR CONDITIONING (AT .5 STATIC PRESSURE), SELECTION OF THE HIGHEST MOTOR SPEED IS REQUIRED.

ALL SPECIFICATIONS ARE SUBJECT TO CHANGE WITHOUT NOTICE.

FURNACE NOMENCLATURE					
C	D	X	3	-75	N
C = CONDENSING	H = HIGHBOY (UPFLOW) D = COUNTERFLOW / HORIZONTAL	A = SERIES B = SERIES X = 2 STAGE, ECM	REVISION LEVEL	INPUT 75,000	NATURAL GAS

SEE NEXT PAGE FOR MORE DATA -

TWO STAGE GAS HIGH-EFFICIENCY COU / HOR FURNACE SPECIFICATIONS

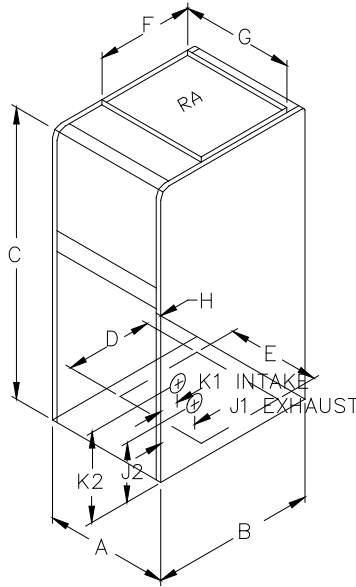

DIM / MODEL	CDX3-75N	CDX3-100N	CDX3-125N
A	17"	21"	24"
B	27-1/2"	27-1/2"	27-1/2"
C	46-1/4"	46-1/4"	46-1/4"
D	18"	18"	18"
E	15"	19"	22"
F	22"	22"	22"
G	15"	19"	22"
H	1"	1"	1"
J1 L	6-1/2"	6-1/2"	6-1/2"
J1 R	2-7/8"	2-7/8"	2-7/8"
J2 L	14-3/4"	14-3/4"	14-3/4"
J2 R	14-7/8"	14-7/8"	14-7/8"
K1 L	2-7/8"	2-7/8"	2-7/8"
K1 R	6-1/2"	6-1/2"	6-1/2"
K2 L	16-1/2"	16-1/2"	16-1/2"
K2 R	17-7/8"	17-7/8"	17-7/8"

COMBUSTIBLE FLOOR BASE

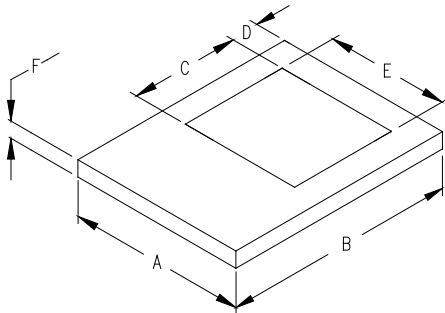

MODEL	50DA-BASE	100CA-BASE	125CA-BASE
DIM - A	17-1/4"	21-1/4"	24-1/4"
DIM - B	27-5/8"	27-5/8"	27-5/8"
DIM - C	18"	18"	18"
DIM - D	1"	1"	1"
DIM - E	15"	19"	22"
DIM - F	2"	2"	2"

SEE NEXT PAGE FOR MORE DATA -

TWO STAGE GAS HIGH-EFFICIENCY COU / HOR FURNACE SPECIFICATIONS

BLOWER DATA:	CDX3-75N	CDX3-100N	CDX3-125N
BLOWER MODEL, DIRECT DRIVE	10-9R DD	10-10R DD	12-11T DD
MOTOR H.P.	1/2	3/4	1
POWER CHOKE	-	2.65 mH	2.1mH

BURNER DATA:			
BURNER TYPE	INSHOT	INSHOT	INSHOT
NO. PER UNIT	3	4	5
MAX INLET PRESSURE (NAT)	14" WC		
MIN INLET PRESSURE (NAT)	4.5" WC		
MAX INLET PRESSURE (LP)	14" WC		
MIN INLET PRESSURE (LP)	11" WC		
NORMAL MANIFOLD PRESS (NAT)	HIGH FIRE 3.5" WC / LOW FIRE 2.0" WC		
NORMAL MANIFOLD PRESS (LP)	HIGH FIRE 10" WC / LOW FIRE 5.6" WC		
ORIFICE SIZE (NAT.)	0.0935" (#42)		
DIA. (D.M.S.) (L.P.)	0.0591" (1.5mm)		

CLEARANCES:			
MINIMUM CLEARANCES TO COMBUSTIBLE MATERIALS:			
SIDES	0"	0"	0"
FRONT (SERVICE ACCESS)	6" (24")	6" (24")	6" (24")
BACK	0"	0"	0"
FLUE PIPE	0"	0"	0"
TOP	1	1	1

GAS HIGH-EFFICIENCY COUNTERFLOW / HORIZONTAL FURNACE SPECIFICATIONS

HEATING SPEEDS

CDX3-75								
Dip switch settings	Low fire CFM	Rise (°F)	Static Pressure (Amps / Watts)		High Fire CFM	Rise (°F)	Static Pressure (Amps / Watts)	
			0.2	0.5			0.2	0.5
S4-3 OFF S4-4 OFF	760	64	1.3 / 104	2.1 / 170	931	70	1.7 / 136	2.6 / 212
S4-3 ON S4-4 OFF	708	69	1.1 / 90	1.9 / 155	867	75	1.5 / 120	2.3 / 197
S4-3 OFF S4-4 ON	826	59	1.4 / 116	2.3 / 197	1012	65	1.9 / 160	2.7 / 231
S4-3 ON S4-4 ON	909	54	1.6 / 128	2.5 / 215	1114	59	2.2 / 190	3.1 / 268

CDX3-100								
Dip switch settings	Low fire CFM	Rise (°F)	Static Pressure (Amps / Watts)		High Fire CFM	Rise (°F)	Static Pressure (Amps / Watts)	
			0.2	0.5			0.2	0.5
S4-3 OFF S4-4 OFF	1015	64	1.5 / 123	2.3 / 182	1243	70	1.8 / 145	2.8 / 242
S4-3 ON S4-4 OFF	947	69	1.3 / 102	2.1 / 176	1160	75	1.6 / 130	2.5 / 218
S4-3 OFF S4-4 ON	1094	60	1.6 / 130	2.5 / 210	1340	65	2.0 / 171	3.0 / 262
S4-3 ON S4-4 ON	1184	55	1.9 / 155	2.8 / 235	1450	60	2.7 / 231	3.8 / 335

CDX3-125								
Dip switch settings	Low fire CFM	Rise (°F)	Static Pressure (Amps / Watts)		High Fire CFM	Rise (°F)	Static Pressure (Amps / Watts)	
			0.2	0.5			0.2	0.5
S4-3 OFF S4-4 OFF	1270	64	2.5 / 205	3.4 / 288	1556	70	3.7 / 320	4.7 / 415
S4-3 ON S4-4 OFF	1185	69	2.2 / 181	3.0 / 250	1452	75	3.4 / 285	4.1 / 365
S4-3 OFF S4-4 ON	1366	60	2.9 / 250	3.8 / 330	1673	65	4.4 / 388	5.4 / 488
S4-3 ON S4-4 ON	1480	55	3.4 / 290	4.2 / 370	1813	60	5.3 / 472	6.4 / 575

=FACTORY SETTING

SEE NEXT PAGE FOR MORE DATA -

GAS HIGH-EFFICIENCY COUNTERFLOW / HORIZONTAL FURNACE SPECIFICATIONS

COOLING SPEED SELECTIONS

CDX3-75

SWITCH SETTINGS						COOLING CFM						CONT. FAN CFM
						SINGLE STAGE OR HIGH			LOW STAGE			
						NORMAL CLG	STATIC PRESSURE (AMPS / WATTS)		DEHUM	NORMAL CLG	DEHUM	
0.2	0.5											
TONS	CFM/TON	S3-1	S3-2	S3-3	S3-4							
2	440	ON	OFF	ON	OFF	880	1.6 / 128	2.4 / 205	750	580	490	400
	400	ON	OFF	OFF	OFF	800	1.4 / 110	2.2 / 185	680	530	450	
	360	ON	OFF	OFF	ON	720	1.2 / 96	2.0 / 164	610	480	400	
2.5	440	OFF	OFF	ON	OFF	1100	2.2 / 189	3.0 / 260	940	730	620	500
	400	OFF	OFF	OFF	OFF	1000	1.9 / 156	2.8 / 242	850	660	560	
	360	OFF	OFF	OFF	ON	900	1.6 / 132	2.5 / 210	770	590	500	
3	440	OFF	ON	ON	OFF	1320	3.2 / 275	4.1 / 358	1120	870	740	600
	400	OFF	ON	OFF	OFF	1200	2.7 / 226	3.5 / 300	1020	790	670	
	360	OFF	ON	OFF	ON	1080	2.2 / 180	3.0 / 260	920	710	610	
3.5	440	ON	ON	ON	OFF	1540	4.5 / 405	5.6 / 509	1310	1020	860	700
	400	ON	ON	OFF	OFF	1400	3.6 / 316	4.6 / 410	1190	920	790	
	360	ON	ON	OFF	ON	1260	2.9 / 250	3.8 / 335	1070	830	710	

CDX3-100

SWITCH SETTINGS						COOLING CFM						CONT. FAN CFM
						SINGLE STAGE OR HIGH			LOW STAGE			
						NORMAL CLG	STATIC PRESSURE (AMPS / WATTS)		DEHUM	NORMAL CLG	DEHUM	
0.2	0.5											
TONS	CFM/TON	S3-1	S3-2	S3-3	S3-4							
2.5	440	ON	OFF	ON	OFF	1100	1.7 / 142	2.6 / 215	940	730	620	500
	400	ON	OFF	OFF	OFF	1000	1.5 / 120	2.3 / 188	850	660	560	
	360	ON	OFF	OFF	ON	900	1.3 / 102	2.1 / 175	770	590	500	
3	440	OFF	OFF	ON	OFF	1320	2.4 / 205	3.4 / 292	1120	870	740	600
	400	OFF	OFF	OFF	OFF	1200	2.0 / 166	2.9 / 250	1020	790	670	
	360	OFF	OFF	OFF	ON	1080	1.7 / 137	2.5 / 212	920	710	610	
3.5	440	OFF	ON	ON	OFF	1540	3.3 / 288	4.4 / 395	1310	1020	860	700
	400	OFF	ON	OFF	OFF	1400	2.7 / 230	3.8 / 334	1190	920	790	
	360	OFF	ON	OFF	ON	1260	2.2 / 182	3.2 / 272	1070	830	710	
4	440	ON	ON	ON	OFF	1760	4.6 / 412	5.8 / 530	1500	1160	990	800
	400	ON	ON	OFF	OFF	1600	3.6 / 315	4.8 / 433	1360	1060	900	
	360	ON	ON	OFF	ON	1440	2.9 / 250	3.9 / 343	1220	950	810	

CDX3-125

SWITCH SETTINGS						COOLING CFM						CONT. FAN CFM
						SINGLE STAGE OR HIGH			LOW STAGE			
						NORMAL CLG	STATIC PRESSURE (AMPS / WATTS)		DEHUM	NORMAL CLG	DEHUM	
0.2	0.5											
TONS	CFM/TON	S3-1	S3-2	S3-3	S3-4							
3	440	ON	OFF	ON	OFF	1320	2.5 / 214	3.4 / 298	1120	870	740	600
	400	ON	OFF	OFF	OFF	1200	2.1 / 178	3.0 / 358	1020	790	670	
	360	ON	OFF	OFF	ON	1080	1.8 / 144	2.5 / 213	920	710	610	
3.5	440	OFF	OFF	ON	OFF	1540	3.5 / 310	4.5 / 398	1310	1020	860	700
	400	OFF	OFF	OFF	OFF	1400	2.9 / 245	3.8 / 333	1190	920	790	
	360	OFF	OFF	OFF	ON	1260	2.4 / 196	3.2 / 276	1070	830	710	
4	440	OFF	ON	ON	OFF	1760	4.7 / 426	5.8 / 535	1500	1160	990	800
	400	OFF	ON	OFF	OFF	1600	3.9 / 343	4.8 / 433	1360	1060	900	
	360	OFF	ON	OFF	ON	1440	3.0 / 258	4.0 / 348	1220	950	810	
5	440	ON	ON	ON	OFF	2200	8.2 / 785	9.4 / 900	1870	1450	1230	1000
	400	ON	ON	OFF	OFF	2000	6.4 / 592	7.6 / 718	1700	1320	1120	
	360	ON	ON	OFF	ON	1800	5.0 / 451	6.1 / 564	1530	1190	1010	

=FACTORY SETTING

SEE NEXT PAGE FOR MORE DATA –

GAS HIGH-EFFICIENCY COUNTERFLOW / HORIZONTAL FURNACE SPECIFICATIONS

FURNACE MODEL	CONDENSER MODEL	LINE SET MODEL	COIL CABINET MODEL	EVAPORATOR COIL MODEL	SEER	EER	TOTAL (BTU/HR) HEAT REMOVAL	SENSIBLE HEAT REMOVAL
CDX3-75N COUNTERFLOW	AC14241G2	LS01E-30	CE105S	13U2430AB15	13.70	11.75	23,600	0.730
		LS01E-50	CE205T	13U3036AB17	14.40	12.15	24,400	0.739
	AC14301G2	LS01E-30	CE105S	13U2430AB15	13.70	11.90	28,000	0.737
		LS01E-50	CE205T	13U3036AB17	14.50	12.40	29,200	0.746
	AC14361G2	LS03E-30	CE105S	13U2430AB15	13.40	11.50	32,600	0.736
		LS03E-50	CE205T	13U3036AB17	14.00	11.95	34,000	0.750
	AC14421G2	LS03E-30	CE205T	13U3642AB17	13.40	11.55	39,500	0.748
		LS03E-50						
CDX3-75N HORIZONTAL	AC14241G2	LS01E-30	N/A	13C2430HA17	14.00	11.85	23,800	0.733
		LS01E-50		13C3036HA17	14.40	12.15	24,400	0.739
	AC14301G2	LS01E-30	N/A	13C2430HA17	14.00	12.05	28,400	0.739
		LS01E-50		13C3036HA17	14.50	12.40	29,200	0.746
	AC14361G2	LS03E-30	N/A	13C2430HA17	13.70	11.70	33,200	0.740
		LS03E-50		13C3036HA17	14.00	11.95	34,000	0.750
	AC14421G2	LS03E-30	N/A	13C3642HA17	13.40	11.55	39,500	0.748
		LS03E-50						

Rev: 3/31/11

FURNACE MODEL	CONDENSER MODEL	LINE SET MODEL	COIL CABINET MODEL	EVAPORATOR COIL MODEL	SEER	EER	TOTAL (BTU/HR) HEAT REMOVAL	SENSIBLE HEAT REMOVAL
CDX3-100N COUNTERFLOW	AC14301G2	LS01E-30	CE107S	13U2430AB15	13.70	11.90	28,000	0.737
		LS01E-50	CE206TA	13U3036AB17	14.50	12.40	29,200	0.746
	AC14361G2	LS03E-30	CE107S	13U2430AB15	13.40	11.50	32,600	0.736
		LS03E-50	CE206TA	13U3036AB17	14.00	11.95	34,000	0.750
	AC14421G2	LS03E-30	CE206TA	13U3642AB17	13.40	11.55	39,500	0.748
		LS03E-50						
	AC14481G2	LS03E-30	CE206TA	13U3642AB17	13.00	11.20	44,500	0.746
		LS03E-50						
CDX3-100N HORIZONTAL	AC14301G2	LS01E-30	N/A	13C2430HA21	14.00	12.05	28,400	0.739
		LS01E-50		13C3036HA21	14.50	12.40	29,200	0.746
	AC14361G2	LS03E-30	N/A	13C2430HA21	13.70	11.70	33,200	0.740
		LS03E-50		13C3036HA21	14.00	11.95	34,000	0.750
	AC14421G2	LS03E-30 LS03E-50	N/A	13C3642HA21	13.40	11.55	39,500	0.748
				13C4248HA21	13.70	11.80	40,500	0.749
				13C4860HA26 ²	14.00	11.90	41,000	0.758
	AC14481G2	LS03E-30 LS03E-50	N/A	13C3642HA21	13.00	11.20	44,500	0.746
13C4248HA21				13.35	11.40	45,500	0.748	
13C4860HA26 ²				13.65	11.80	47,000	0.758	

² adaption required

Rev: 3/31/11

SEE NEXT PAGE FOR MORE DATA –

GAS HIGH-EFFICIENCY COUNTERFLOW / HORIZONTAL FURNACE SPECIFICATIONS

FURNACE MODEL	CONDENSER MODEL	LINE SET MODEL	COIL CABINET MODEL	EVAPORATOR COIL MODEL	SEER	EER	TOTAL (BTU/HR) HEAT REMOVAL	SENSIBLE HEAT REMOVAL
CDX3-125N COUNTERFLOW	AC14361G2	LS03E-30 LS03E-50	CE108S	13U2430AB15	13.40	11.50	32,600	0.736
			CE108S	13U3030AB15	13.70	11.70	33,200	0.740
			CE208TA	13U3036AB17	14.00	11.95	34,000	0.750
	AC14421G2	LS03E-30 LS03E-50	CE208TA	13U3642AB17	13.40	11.55	39,500	0.748
	AC14481G2	LS03E-30 LS03E-50	CE208TA	13U3642AB17	13.00	11.20	44,500	0.746
	AC14601G2	LS03E-30 LS03E-50						
CDX3-125N HORIZONTAL	AC14361G2	LS03E-30 LS03E-50	N/A	13C2430HA23	13.70	11.70	33,200	0.740
				13C3036HA23	14.00	11.95	34,000	0.750
	AC14421G2	LS03E-30 LS03E-50	N/A	13C3642HA23	13.40	11.55	39,500	0.748
				13C4248HA23	13.70	11.80	40,500	0.749
				13C4860HA26 ¹	14.00	11.90	41,000	0.758
	AC14481G2	LS03E-30 LS03E-50	N/A	13C3642HA23	13.00	11.20	44,500	0.746
				13C4248HA23	13.35	11.40	45,500	0.748
				13C4860HA26 ¹	13.65	11.80	47,000	0.758
	AC14601G2	LS03E-30 LS03E-50	N/A	13C4860HA26 ¹	13.00	11.20	58,000	0.753

¹Needs plenum adapter AOPS7693