

SPECIFICATIONS

MODEL PGL20-180D FUEL GAS NAT/LP
 BTU/HR. INPUT 180,000 BTU/HR. OUTPUT 144,000
 * SEASONAL EFFICIENCY 79.2% w/VENT DAMPER 82.7%
 TEMP. RISE 70° FLUE DIA. 7"
 FILTER SIZE (2) 14"x25"
 APPROXIMATE SHIPPING WEIGHT 600 lbs.
 APPROXIMATE EFFECTIVE HEATING SURFACE 7525 sq. in.
 AGENCY APPROVAL NO. N/A
 ELECTRICAL RATING 115V 60HZ
 TOTAL CURRENT AMPS 19.6 MAX FUSE SIZE 25
 FAN CENTER EQUIPPED YES

BLOWER DATA

BLOWER MODEL 10-9 DD
 MOTOR H.P. 3/4

BURNER DATA

BURNER MODEL MIDCO SPEC. NO. RE32
 AIR TUBE LENGTH 8"
 ORIFICE NAT. .277 NORMAL MANIFOLD PRESSURE 3.0" W.C. NAT.
 L.P. .213 NORMAL MANIFOLD PRESSURE 3.0" W.C. L.P.
 REFRACTORY #16

CLEARANCES

MINIMUM CLEARANCES TO COMBUSTIBLE MATERIALS
 SIDES 6"
 FRONT (SERVICE ACCESS) 24"
 REAR 6"
 FLUE/VENT 18"
 TOP & SIDES OF PLENUM 2"

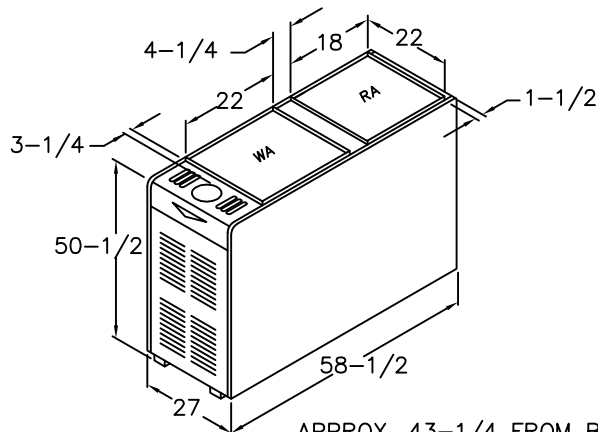

APPROX. 43-1/4 FROM BASE
 OF UNIT TO CENTERLINE OF
 THE FLUE PIPE ON H.E.

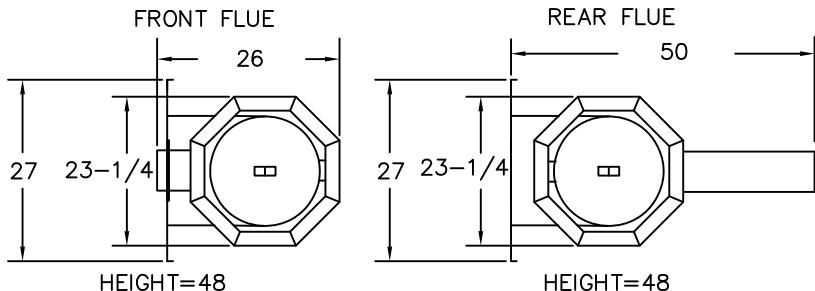

SEE NEXT PAGE FOR MORE DATA —