

SPECIFICATIONS

MODEL PGL20-180D FUEL GAS NAT/LP
 BTU/HR. INPUT 180,000 BTU/HR. OUTPUT 144,000
 * SEASONAL EFFICIENCY 79.2% w/VENT DAMPER 82.7%
 TEMP. RISE 70° FLUE DIA. 7"
 FILTER SIZE (2) 14"x25"
 APPROXIMATE SHIPPING WEIGHT 600 lbs.
 APPROXIMATE EFFECTIVE HEATING SURFACE 7525 sq. in.
 AGENCY APPROVAL NO. N/A
 ELECTRICAL RATING 115V 60HZ
 TOTAL CURRENT AMPS 19.6 MAX FUSE SIZE 25
 FAN CENTER EQUIPPED YES

BLOWER DATA

BLOWER MODEL 10-9 DD
 MOTOR H.P. 3/4

BURNER DATA

BURNER MODEL MIDCO SPEC. NO. RE32
 AIR TUBE LENGTH 8"
 ORIFICE NAT. .277 NORMAL MANIFOLD PRESSURE 3.0" W.C. NAT.
 L.P. .213 NORMAL MANIFOLD PRESSURE 3.0" W.C. L.P.
 REFRACTORY #16

CLEARANCES

MINIMUM CLEARANCES TO COMBUSTIBLE MATERIALS
 SIDES 6"
 FRONT (SERVICE ACCESS) 24"
 REAR 6"
 FLUE/VENT 18"
 TOP & SIDES OF PLENUM 2"

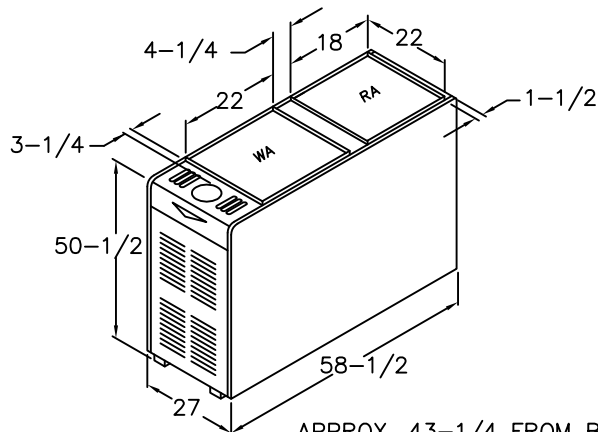

APPROX. 43-1/4 FROM BASE OF UNIT TO CENTERLINE OF THE FLUE PIPE ON H.E.

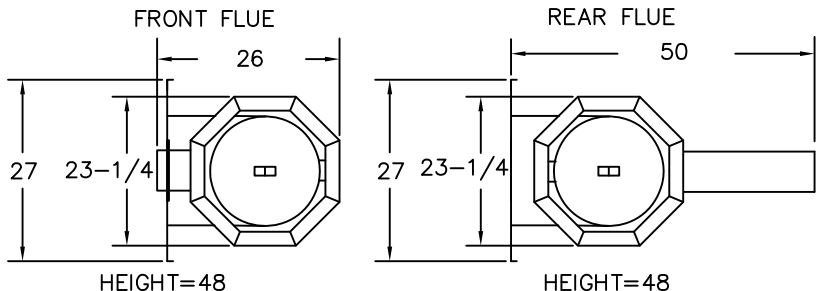

SEE NEXT PAGE FOR MORE DATA —

SPECIFICATIONS

MODEL PGL33-250B FUEL GAS NAT/LP
 BTU/HR. INPUT 250,000 BTU/HR. OUTPUT 200,000
 SEASONAL EFFICIENCY 79.3% w/VENT DAMPER 82.8%
 TEMP. RISE 85° FLUE DIA. 9"
 FILTER SIZE (2) 2" x 20" x 25"
 APPROXIMATE SHIPPING WEIGHT 1025 lbs.
 APPROXIMATE EFFECTIVE HEATING SURFACE 12,000 sq. in.
 AGENCY APPROVAL NO. N/A
 ELECTRICAL RATING 115V 60HZ
 TOTAL CURRENT AMPS 13.8 MAX FUSE SIZE 20
 FAN CENTER EQUIPPED NO

BLOWER DATA

BLOWER MODEL 15-15 BD
 MOTOR H.P. 1/2
 BLOWER PULLEY 10 x 1
 * MOTOR PULLEY 3-1/4 x 1/2
 BELT SIZE 53

BURNER DATA

BURNER MODEL WAYNE SPEC. NO. HSG-400
 AIR TUBE LENGTH 5-3/4" HEAD N/A
 ORIFICE NAT. .332
 L.P. .265
 REFRACTORY #3F

CLEARANCES

MINIMUM CLEARANCES TO COMBUSTIBLE MATERIALS
 SIDES 2"
 FRONT (SERVICE ACCESS) 24"
 REAR 6"
 FLUE/VENT 18"
 TOP & SIDES OF PLENUM 2"

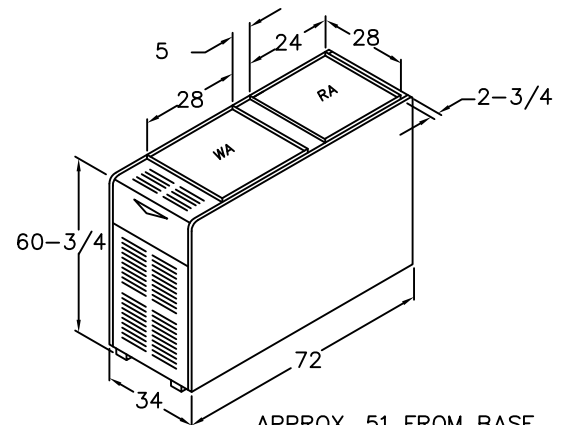
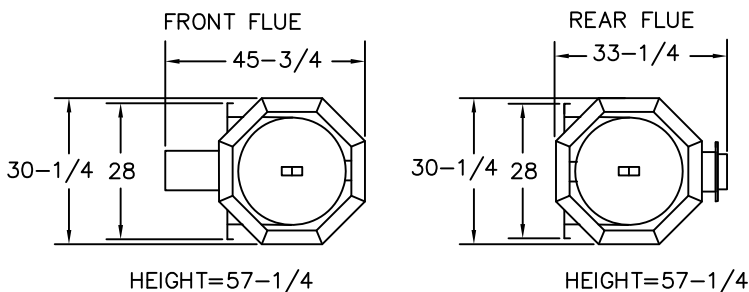

APPROX. 51 FROM BASE OF UNIT TO CENTERLINE OF THE FLUE PIPE ON H.E.