



14 SEER HEAT PUMP SYSTEM SPECIFICATIONS¹

OUTDOOR UNIT	LINE SET MODEL	RESISTIVE HEATERS	INDOOR COIL MODEL		SEER	EER	HSPF	COOLING		HEATING			
			A - STYLE	H - STYLE				TOTAL (BTU/HR) HEAT REMOVAL	SENSIBLE HEAT REMOVAL %	47°		17°	
										BTU/HR	COP	BTU/HR	COP
HP14241B1	LS01E-30 LS01E-50		13U3030AB15		13.40	12.00	8.20	24,200	0.744	22,000	3.60	12,800	2.25
			13C2430AA17	13C2430HA17									
			13C2430AA19	13C2430HA19									
			13C2430AA21	13C2430HA21									
			13C2430AA23	13C2430HA23									
EH104A EH108A	AH2436XE1	15.40	13.50	8.80	25,200	0.749	21,600	3.90	12,200	2.40			
10kw	PCME32924T102	13.00	11.65	8.10	24,000	0.754	22,400	3.60	13,000	2.25			
HP14301B1	LS01E-30 LS01E-50		13U3036AB17		13.25	11.80	8.40	29,000	0.762	26,000	3.65	15,000	2.30
			13C3036AA17	13C3036HA17									
			13C3036AA19	13C3036HA19									
			13C3036AA21	13C3036HA21									
			13C3036AA23	13C3036HA23									
EH104A EH108A	AH2436HE1	14.70	13.00	8.85	29,600	0.760	26,200	3.90	14,800	2.45			
HP14361B1	LS02E-30 LS02E-50		13U3036AB17		13.65	12.20	8.90	34,800	0.756	32,400	3.80	19,400	2.45
			13C3036AA17	13C3036HA17									
			13C3036AA19	13C3036HA19									
			13C3036AA21	13C3036HA21									
			13C3036AA23	13C3036HA23									
EH104A EH108A	AH2436HE1	14.40	12.85	9.05	35,200	0.756	31,800	3.90	19,000	2.50			
HP14421B1	LS02E-30 LS02E-50		13U3642AB17		13.50	12.00	9.10	41,000	0.747	39,000	3.85	23,600	2.50
			13C3642AA17	13C3642HA17									
			13C3642AA19	13C3642HA19									
			13C3642AA21	13C3642HA21									
			13C3642AA23	13C3642HA23									
			13U4248AB20		14.00	12.40	9.10	42,000	0.749	39,500	3.95	23,600	2.50
			13C4248HA21										
13C4248HA23													
EH208A EH212A EH216A	AH4260HE1	15.60	13.70	9.60	43,000	0.74	38,500	4.20	22,600	2.70			
HP14481B1 HP14483B1	LS02E-30 LS02E-50		13U4248AB20		13.50	12.10	8.90	48,000	0.747	45,000	3.70	27,200	2.50
			13C4248HA21										
			13C4248HA23										
EH208A EH212A EH216A	AH4260HE1	13.80	12.30	9.10	49,500	0.800	45,500	3.96	27,000	2.52			
HP14601B1 HP14603B1	LS02E-30 LS02E-50		13C4860HA26		13.30	11.80	9.10	60,000	0.728	57,000	3.75	35,000	2.55
			EH208A EH212A EH216A	AH4260AE1									

¹ ALL SPECIFICATIONS ARE SUBJECT TO CHANGE WITHOUT NOTICE

HEAT PUMP SPECIFICATIONS

MODEL#	HP14241B1	HP14301B1	HP14361B1	HP14421B1	HP14481B1	HP14483B1	HP14601B1	HP14603B1
ELECTRICAL DATA								
VOLTAGE/PHASE/HERTZ	208-230/1/60	208-230/1/60	208-230/1/60	208-230/1/60	208-230/1/60	208-230/3/60	208-230/1/60	208-230/3/60
COMPRESSOR	ZP20K5E-PFV	ZP24K5E-PFV	ZP29K5E-PFV	ZP34K5E-PFV	ZP39K5E-PFV	ZP39K5E-TF5	ZP51K5E-PFV	ZP51K5E-TF5
RLA	13.5	12.8	14.1	17.9	19.9	13.1	26.4	16
LRA	58.3	64	77	112	109	83.1	134	110
MAX FUSE OR BREAKER	25	25	25	30	35	25	40	30
RECOMMENDED FUSE	20	20	20	25	30	20	35	25
WIRE SIZE (AWG)	12	12	12	10	10	12	8	10
OUTDOOR COIL								
FACE AREA (SQ FT)	12.3	12.3	17.2	16.5	16.5	16.5	16.5	16.5
ROWS DEEP	1	1	1	2	2	2	2	2
FINS PER INCH	16	16	16	15	15	15	15	15
FIN TYPE	LOUVERED	LOUVERED	LOUVERED	LOUVERED	LOUVERED	LOUVERED	LOUVERED	LOUVERED
TUBING OD (IN)	1 x 0.086	1 x 0.086	1 x 0.086	3/8	3/8	3/8	3/8	3/8
OUTDOOR FAN								
TYPE	AXIAL	AXIAL	AXIAL	AXIAL	AXIAL	AXIAL	AXIAL	AXIAL
CFM	2600	2600	2800	2800	3900	3900	4500	4500
DIAMETER (IN)	22	22	24	24	24	24	24	24
NO. OF BLADES	3	3	3	3	3	3	3	3
OUTDOOR FAN MOTOR								
HP	1/8	1/8	1/8	1/8	1/4	1/4	1/3	1/3
RPM	825	825	825	825	825	825	1100	1100
FLA	0.8	0.8	0.8	0.8	1.6	1.6	2.1	2.1
REFRIGERANT-410aFURNISHED (OZ)	80	80	92	160	160	160	160	160
SHIPPING WEIGHT (LB)	164	164	189	211	212	207	215	212
LIQUID LINE CONNECTION (ODF IN)	3/8	3/8	3/8	3/8	3/8	3/8	3/8	3/8
SUCTION LINE CONNECTION (ODF IN)	3/4	3/4	7/8	7/8	7/8	7/8	7/8	7/8
OVERALL DIMENSIONS (IN)								
A	26.75	26.75	29	29	29	29	29	29
B	28	28	30.25	30.25	30.25	30.25	30.25	30.25
C	31.5	31.5	36.25	35.75	35.75	35.75	35.75	35.75

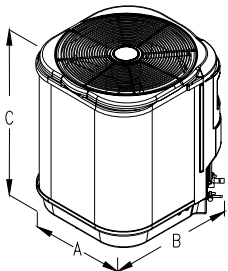

HEAT PUMP NOMENCLATURE				
HP	14	24	1	B1
AC - AIR CONDITIONER HP - HEAT PUMP	NOMINAL 14 SEER	CAPACITY 24,000	1 = SINGLE PHASE 3 = THREE PHASE	REVISION LEVEL

SEE NEXT PAGE FOR MORE DATA -

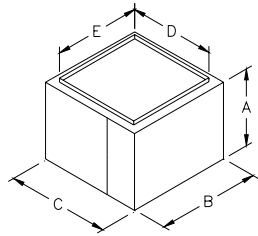

LINE SET SPECIFICATIONS

LINE SET MODEL	LS01E-30	LS01E-50	LS02E-30	LS02E-50
LIQUID LINE (OD IN)	3/8	3/8	3/8	3/8
SUCTION LINE ¹ (OD IN)	3/4	3/4	7/8	7/8
LENGTH (FT)	30	50	25	50

(CASED) INDOOR COIL SPECIFICATIONS

FOR HIGHBOY / LOWBOY/ HORIZONTAL FURNACE

DIMENSIONAL NOTES:

- ¹"A" =CABINET HEIGHT NOT INCLUDING 3/4" DUCT FLANGE.
- "F" =BOTTOM OPENING DEPTH
- "G" =BOTTOM OPENING WIDTH
- "H" =LIQUID LINE CONNECTION ODF
- "J" = SUCTION LINE CONNECTION ODF
- CONDENSATE DRAIN = 3/4"

INDOOR COIL NOMENCLATURE					
13	C	2430	A	A	17
13 – TXV,R410a, w/INTERNAL CHECK	C = CASED U = UNCASED	CAPACITY RANGE 24,000 – 30,000	A = UPFLOW H = HORIZ / UPFLOW	REVISION LEVEL	WIDTH (NOMINAL INCHES)

INDOOR COIL MODEL	A	B	C	D	E	F	G	H	J	APPROX WET COIL PRESSURE DROP (IN H ₂ O)					
										800	1000	1200	1400	1600	2000
13C2430AA17	18.5	20.5	17	15.5	19	20	16	.375	.75	.17	.19	.24			
13C2430AA19	18.5	20.5	19	17.5	19	20	18	.375	.75	.17	.19	.24			
13C2430AA21	18.5	20.5	21	19.5	19	20	20	.375	.75	.17	.19	.24			
13C2430AA23	18.5	21	23	21.5	19.5	20.5	22	.375	.75	.17	.19	.24			
13C3036AA17	25.5	20.5	17	15.5	19	20	16	.375	.75		.14	.22	.25		
13C3036AA19	25.5	20.5	19	17.5	19	20	18	.375	.75		.14	.22	.25		
13C3036AA21	25.5	20.5	21	19.5	19	20	20	.375	.75		.14	.22	.25		
13C3036AA23	25.5	21	23	21.5	19.5	20.5	22	.375	.75		.14	.22	.25		
13C3642AA17	25.5	20.5	17	15.5	19	20	16	.375	.875			.22	.25	.28	
13C3642AA19	25.5	20.5	19	17.5	19	20	18	.375	.875			.22	.25	.28	
13C3642AA21	25.5	20.5	21	19.5	19	20	20	.375	.875			.22	.25	.28	
13C3642AA23	25.5	21	23	21.5	19.5	20.5	22	.375	.875			.22	.25	.28	
13C2430HA17	20.5	20.5	17	15.5	19	20	16	.375	.75	.17	.19	.24			
13C2430HA19	20.5	20.5	19	17.5	19	20	18	.375	.75	.17	.19	.24			
13C2430HA21	20.5	20.5	21	19.5	19	20	20	.375	.75	.17	.19	.24			
13C2430HA23	20.5	21	23	21.5	19.5	20.5	22	.375	.75	.17	.19	.24			
13C3036HA17	25.5	20.5	17	15.5	19	20	16	.375	.75		.14	.22	.25		
13C3036HA19	25.5	20.5	19	17.5	19	20	18	.375	.75		.14	.22	.25		
13C3036HA21	25.5	20.5	21	19.5	19	20	20	.375	.75		.14	.22	.25		
13C3036HA23	25.5	20.5	23	21.5	19	20	22	.375	.75		.14	.22	.25		
13C3642HA17	25.5	20.5	17	15.5	19	20	16	.375	.875			.22	.25	.28	
13C3642HA19	25.5	20.5	19	17.5	19	20	18	.375	.875			.22	.25	.28	
13C3642HA21	25.5	20.5	21	19.5	19	20	20	.375	.875			.22	.25	.28	
13C3642HA23	25.5	20.5	23	21.5	19	20	22	.375	.875			.22	.25	.28	
13C4248HA21	27.5	21	21	19.5	19.5	20.5	20	.375	.875			.13	.23	.26	.28
13C4248HA23	27.5	21	23	21.5	19.5	20.5	22	.375	.875			.13	.23	.26	.28
13C4860HA26	29.5	21	25.75	24.25	19.5	20.5	24.75	.375	.875			.28	.29	.30	

¹ INSULATION THICKNESS 1/2"

SEE NEXT PAGE FOR MORE DATA -

(UNCASED) INDOOR COIL SPECIFICATIONS

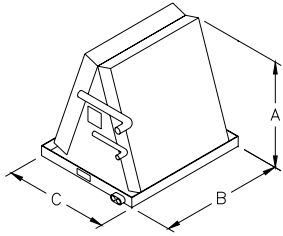

EVAPORATOR COIL MODEL	A	B	C	H	J	APPROX WET COIL PRESSURE DROP (IN H ₂ O)					
						800	1000	1200	1400	1600	2000
13U3030AB15	17	19.5	15.5	.375	.75	.18	.22	.28			
13U3036AB17	23	19.5	17	.375	.75		.14	.22	.25		
13U3642AB17	23	19.5	17	.375	.875			.22	.25	.28	
13U4248AB20	27	19.5	20.5	.375	.875			.13	.23	.26	.28

DIMENSIONAL NOTES:

"H" = LIQUID LINE CONNECTION ODF
 "J" = SUCTION LINE CONNECTION ODF
 CONDENSATE DRAIN = 3/4"

COIL CABINET SPECIFICATIONS FOR COUNTERFLOW FURNACE

COIL CABINET MODEL	CE105S	CE106S	CE107S	CE108S	CE109S	CE111S	CE112S	CE205T	CE206TA
USED W/ COIL MODEL	13U3030AB15	13U3030AB15	13U3030AB15	13U3030AB15	13U3030AB15	13U3030AB15	13U3030AB15	13U3642AB17 13U3036AB17	13U3642AB17 13U3036AB17
A	20	20	20	20	20	20	17.875	24.50	24.50
B	27.75	27.75	27.75	27.75	33.25	24.25	30.0	27.75	30.5
C	17.25	19.25	21.25	24.25	24.25	18.25	20.0	17.75	22.25
D	14	14	14	14	14	14	14	14	15
E	16.50	16.50	16.50	16.5	16.50	16.50	16.50	16.50	17
F	1.25	1.25	1.25	1.25	6.75	1.25	1.625	1.5	1.25

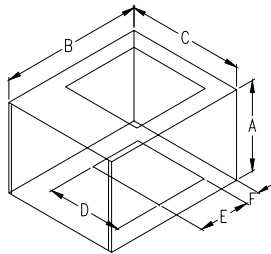

COIL CABINET MODEL	CE208TA	CE209TA	CE211T	CE212T	CE312T
USED W/ COIL MODEL	13U3642AB17 13U3036AB17	13U3642AB17 13U3036AB17	13U3642AB17 13U3036AB17	13U3642AB17 13U3036AB17	13U4248AB20 13C4860HA26 ¹
A	26.50	24.50	24.50	24.375	29.5
B	30.5	33.25	24.25	30.0	30.0
C	24.25	24.25	18.25	20.0	23.25
D	16	15.50	14	14	14
E	17	17	16.5	16.5	16.0/20.0 ²
F	1.25	6.5	1.25	1.625	4.625

¹ COIL MUST BE REMOVED FROM CASING

² 13C4860HA26 COIL