



**TWO STAGE GAS HIGH EFFICIENCY  
COUNTERFLOW / HORIZONTAL FURNACE SPECIFICATIONS**

<b>MODEL NO.</b>	<b>CDX1-75N</b>	<b>CDX1-100N</b>	<b>CDX1-125N</b>
<b>FUEL</b>	GAS NAT/LP	GAS NAT/LP	GAS NAT/LP
<b>INPUT BTUH (HIGH FIRE / LOW FIRE)</b>	75,000 / 56,250	100,000 / 75,000	125,000 / 93,750
<b>OUTPUT BTUH<sup>1</sup></b>	71,000 / 52,000	94,000 / 70,000	116,000 / 87,000
<b>SEASONAL EFFICIENCY<sup>2</sup></b>	93.0%	93.0%	93.0%
<b>LARGEST REC A/C<sup>3</sup></b>	3.5 T	4 T	5 T
<b>NOMINAL TEMP RISE</b>	65° / 60°	65° / 60°	65° / 60°
<b>APPROX EFFECTIVE HEATING SURFACE</b>	5950 SQ IN	6500 SQ IN	7025 SQ IN
<b>APPROX SHIPPING WEIGHT</b>	195 LBS	210 LBS	243 LBS
<b>APPROVAL AGENCY</b>	CSA	CSA	CSA
<b>DIA OF FLUE (PVC)</b>	2"	3"	3"
<b>DIA OF COMBUSTION AIRINTAKE (PVC)</b>	2"	3"	3"
<b>QTY AND SIZE OF PERMANENT FILTERS</b>	TWO 1" x 22" x 14"	TWO 1" x 22" x 14"	TWO 1" x 22" x 14"
<b>ELECTRICAL RATING</b>	115V 60HZ 1PH	115V 60HZ 1PH	115V 60HZ 1PH
<b>MAX FUSE SIZE</b>	15 AMP	15 AMP	20 AMP
<b>ACCESSORY ITEMS</b>			
<b>COMBUSTIBLE FLOOR BASE</b>	50DA-BASE	100CA-BASE	125CA-BASE
<b>PROGRAMMABLE T-STAT STD/DELUXE</b>	350164 / 350165	350164 / 350165	350164 / 350165
<b>CONCENTRIC VENT KIT</b>	AOPS7488	AOPS7489	AOPS7489
<b>SIDEWALL VENT CAP</b>	370191	370191	370191
<b>NEUTRALIZER KIT</b>	320095	320095	320095
<b>CONDENSATE PUMP</b>	350225	350225	350225
<b>NAT. CONVERSION KIT</b>	-	-	-
<b>LP CONVERSION KIT</b>	AOPS7682	AOPS7683	AOPS7419
<b>FURNACE PARTS KIT</b>	AOPS7428	AOPS7428	AOPS7428

<sup>1</sup> OUTPUT BTUH BASED ON ANNUAL FUEL UTILIZATION EFFICIENCY RATED BY MANUFACTURER.

<sup>2</sup> SEASONAL EFFICIENCY (ALSO CALLED AFUE - ANNUAL FUEL UTILIZATION EFFICIENCY) RATINGS ARE BASED ON TESTS FOLLOWING U.S. DEPARTMENT OF ENERGY TEST PROCEDURES.

<sup>3</sup> TO PERMIT LARGEST RECOMMENDED AIR CONDITIONING (AT .5 STATIC PRESSURE), SELECTION OF THE HIGHEST MOTOR SPEED IS REQUIRED.

ALL SPECIFICATIONS ARE SUBJECT TO CHANGE WITHOUT NOTICE.

<b>FURNACE NOMENCLATURE</b>					
<b>C</b>	<b>H</b>	<b>B</b>	<b>1</b>	<b>-50</b>	<b>N</b>
C = CONDENSING	H = HIGHBOY (UPFLOW) D = COUNTERFLOW / HORIZONTAL	A = SERIES B = SERIES X = 2 STAGE, ECM	REVISION LEVEL	INPUT 50,000	NATURAL GAS

**SEE NEXT PAGE FOR MORE DATA -**

# TWO STAGE GAS HIGH-EFFICIENCY COU / HOR FURNACE SPECIFICATIONS

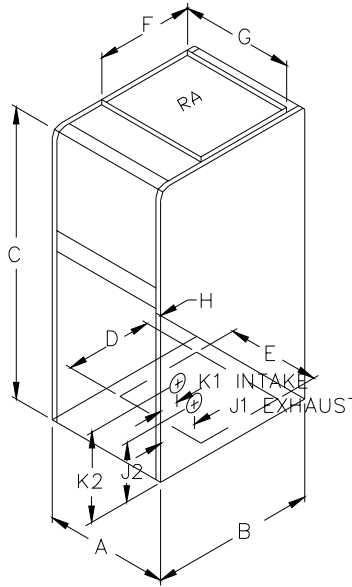

DIM / MODEL	CDX1-75N	CDX 1-100N	CDX1-125N
A	17"	21"	24"
B	27-1/2"	27-1/2"	27-1/2"
C	46-1/4"	46-1/4"	46-1/4"
D	18"	18"	18"
E	15"	19"	22"
F	18"	18"	18"
G	15"	19"	22"
H	1"	1"	1"
J1 L	6-1/2"	6-1/2"	6-1/2"
J1 R	2-7/8"	2-7/8"	2-7/8"
J2 L	14-3/4"	14-3/4"	14-3/4"
J2 R	14-7/8"	14-7/8"	14-7/8"
K1 L	2-7/8"	2-7/8"	2-7/8"
K1 R	6-1/2"	6-1/2"	6-1/2"
K2 L	16-1/2"	16-1/2"	16-1/2"
K2 R	17-7/8"	17-7/8"	17-7/8"

## COMBUSTIBLE FLOOR BASE

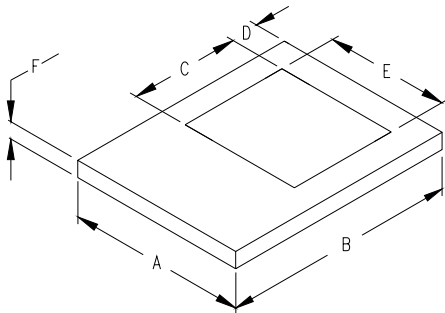

MODEL	50DA-BASE	100CA-BASE	125CA-BASE
DIM - A	17-1/4"	21-1/4"	24-1/4"
DIM - B	27-5/8"	27-5/8"	27-5/8"
DIM - C	18"	18"	18"
DIM - D	1"	1"	1"
DIM - E	15"	19"	22"
DIM - F	2"	2"	2"

## TWO STAGE GAS HIGH-EFFICIENCY COU / HOR FURNACE SPECIFICATIONS

<b>BLOWER DATA:</b>	<b>CDX1-75N</b>	<b>CDX1-100N</b>	<b>CDX1-125N</b>
BLOWER MODEL <sup>1</sup>	10-9R DD	10-10R DD	12-11T DD
MOTOR H.P.	1/2	3/4	1
POWER CHOKE	-	2.65 mH	2.1mH

<b>BURNER DATA:</b>			
BURNER TYPE	INSHOT	INSHOT	INSHOT
NO. PER UNIT	3	4	5
MAX INLET PRESSURE (NAT)	14" WC		
MIN INLET PRESSURE (NAT)	4.5" WC		
MAX INLET PRESSURE (LP)	14" WC		
MIN INLET PRESSURE (LP)	11" WC		
NORMAL MANIFOLD PRESS (NAT)	HIGH FIRE 3.5" WC / LOW FIRE 2.0" WC		
NORMAL MANIFOLD PRESS (LP)	HIGH FIRE 10" WC / LOW FIRE 5.6" WC		
ORIFICE SIZE (NAT.)	0.0935" (#42)		
DIA. (D.M.S.) (L.P.)	0.0591" (1.5mm)		

<b>CLEARANCES:</b>			
MINIMUM CLEARANCES TO COMBUSTIBLE MATERIALS:			
SIDES	0"	0"	0"
FRONT (SERVICE ACCESS)	6" (24")	6" (24")	6" (24")
BACK	0"	0"	0"
FLUE PIPE	0"	0"	0"
TOP	1	1	1

<sup>1</sup> DD = DIRECT DRIVE

# GAS HIGH-EFFICIENCY COUNTERFLOW / HORIZONTAL FURNACE SPECIFICATIONS

## HEATING SPEEDS

CDX1-75				
Dip switch settings	Low fire CFM	Rise (°F)	High Fire CFM	Rise (°F)
7-OFF 8-OFF	760	64	931	70
7-ON 8-OFF	708	69	867	75
7-OFF 8-ON	826	59	1012	65
7-ON 8-ON	909	54	1114	59

CDX1-100				
Dip switch settings	Low fire CFM	Rise (°F)	High Fire CFM	Rise (°F)
7-OFF 8-OFF	1015	64	1243	70
7-ON 8-OFF	947	69	1160	75
7-OFF 8-ON	1094	60	1340	65
7-ON 8-ON	1184	55	1450	60

CDX1-125				
Dip switch settings	Low fire CFM	Rise (°F)	High Fire CFM	Rise (°F)
7-OFF 8-OFF	1270	64	1556	70
7-ON 8-OFF	1185	69	1452	75
7-OFF 8-ON	1366	60	1673	65
7-ON 8-ON	1480	55	1813	60



= FACTORY SHIPPED SETTINGS

SEE NEXT PAGE FOR MORE DATA -

# GAS HIGH-EFFICIENCY COUNTERFLOW / HORIZONTAL FURNACE SPECIFICATIONS

## COOLING SPEED SELECTIONS

**CDX1-75**

TONS	CFM/TON	SWITCH SETTINGS				COOLING CFM				CONT. FAN CFM
						SINGLE STAGE OR HIGH		LOW STAGE		
						NORMAL CLG	DEHUM	NORMAL CLG	DEHUM	
2	440	ON	OFF	ON	OFF	880	750	580	490	400
	<b>400</b>	<b>ON</b>	<b>OFF</b>	<b>OFF</b>	<b>OFF</b>	<b>800</b>	<b>680</b>	<b>530</b>	<b>450</b>	
	360	ON	OFF	OFF	ON	720	610	480	400	
2.5	440	OFF	OFF	ON	OFF	1100	940	730	620	500
	<b>400</b>	<b>OFF</b>	<b>OFF</b>	<b>OFF</b>	<b>OFF</b>	<b>1000</b>	<b>850</b>	<b>660</b>	<b>560</b>	
	360	OFF	OFF	OFF	ON	900	770	590	500	
3	440	OFF	ON	ON	OFF	1320	1120	870	740	600
	<b>400</b>	<b>OFF</b>	<b>ON</b>	<b>OFF</b>	<b>OFF</b>	<b>1200</b>	<b>1020</b>	<b>790</b>	<b>670</b>	
	360	OFF	ON	OFF	ON	1080	920	710	610	
3.5	440	ON	ON	ON	OFF	1540	1310	1020	860	700
	<b>400</b>	<b>ON</b>	<b>ON</b>	<b>OFF</b>	<b>OFF</b>	<b>1400</b>	<b>1190</b>	<b>920</b>	<b>790</b>	
	360	ON	ON	OFF	ON	1260	1070	830	710	

**CDX1-100**

TONS	CFM/TON	SWITCH SETTINGS				COOLING CFM				CONT. FAN CFM
						SINGLE STAGE OR HIGH		LOW STAGE		
						NORMAL CLG	DEHUM	NORMAL CLG	DEHUM	
2.5	440	ON	OFF	ON	OFF	1100	940	730	620	500
	<b>400</b>	<b>ON</b>	<b>OFF</b>	<b>OFF</b>	<b>OFF</b>	<b>1000</b>	<b>850</b>	<b>660</b>	<b>560</b>	
	360	ON	OFF	OFF	ON	900	770	590	500	
3	440	OFF	OFF	ON	OFF	1320	1120	870	740	600
	<b>400</b>	<b>OFF</b>	<b>OFF</b>	<b>OFF</b>	<b>OFF</b>	<b>1200</b>	<b>1020</b>	<b>790</b>	<b>670</b>	
	360	OFF	OFF	OFF	ON	1080	920	710	610	
3.5	440	OFF	ON	ON	OFF	1540	1310	1020	860	700
	<b>400</b>	<b>OFF</b>	<b>ON</b>	<b>OFF</b>	<b>OFF</b>	<b>1400</b>	<b>1190</b>	<b>920</b>	<b>790</b>	
	360	OFF	ON	OFF	ON	1260	1070	830	710	
4	440	ON	ON	ON	OFF	1760	1500	1160	990	800
	<b>400</b>	<b>ON</b>	<b>ON</b>	<b>OFF</b>	<b>OFF</b>	<b>1600</b>	<b>1360</b>	<b>1060</b>	<b>900</b>	
	360	ON	ON	OFF	ON	1440	1220	950	810	

**CDX1-125**

TONS	CFM/TON	SWITCH SETTINGS				COOLING CFM				CONT. FAN CFM
						SINGLE STAGE OR HIGH		LOW STAGE		
						NORMAL CLG	DEHUM	NORMAL CLG	DEHUM	
3	440	ON	OFF	ON	OFF	1320	1120	870	740	600
	<b>400</b>	<b>ON</b>	<b>OFF</b>	<b>OFF</b>	<b>OFF</b>	<b>1200</b>	<b>1020</b>	<b>790</b>	<b>670</b>	
	360	ON	OFF	OFF	ON	1080	920	710	610	
3.5	440	OFF	OFF	ON	OFF	1540	1310	1020	860	700
	<b>400</b>	<b>OFF</b>	<b>OFF</b>	<b>OFF</b>	<b>OFF</b>	<b>1400</b>	<b>1190</b>	<b>920</b>	<b>790</b>	
	360	OFF	OFF	OFF	ON	1260	1070	830	710	
4	440	OFF	ON	ON	OFF	1760	1500	1160	990	800
	<b>400</b>	<b>OFF</b>	<b>ON</b>	<b>OFF</b>	<b>OFF</b>	<b>1600</b>	<b>1360</b>	<b>1060</b>	<b>900</b>	
	360	OFF	ON	OFF	ON	1440	1220	950	810	
5	440	ON	ON	ON	OFF	2200	1870	1450	1230	1000
	<b>400</b>	<b>ON</b>	<b>ON</b>	<b>OFF</b>	<b>OFF</b>	<b>2000</b>	<b>1700</b>	<b>1320</b>	<b>1120</b>	
	360	ON	ON	OFF	ON	1800	1530	1190	1010	

**FACTORY SETTINGS**

**SEE NEXT PAGE FOR MORE DATA –**

## GAS HIGH-EFFICIENCY COUNTERFLOW / HORIZONTAL FURNACE SPECIFICATIONS

FURNACE MODEL	CONDENSER MODEL	LINE SET MODEL	COIL CABINET MODEL	EVAPORATOR COIL MODEL	SEER	EER	TOTAL (BTU/HR) HEAT REMOVAL	SENSIBLE HEAT REMOVAL
CDX1-75N COUNTERFLOW	AC14241G2	LS01E-30 LS01E-50	CE105S	13U2430AB15	13.80	12.30	24,000	0.730
			CE205T	13U3036AB17	14.40	12.70	25,400	0.739
	AC14301G2	LS01E-30 LS01E-50	CE105S	13U2430AB15	13.70	12.30	29,000	0.737
			CE205T	13U3036AB17	14.50	13.00	30,400	0.746
	AC14361G2	LS03E-30 LS03E-50	CE105S	13U2430AB15	13.40	11.95	33,800	0.736
			CE205T	13U3036AB17	14.00	12.50	35,600	0.750
	AC14421G2	LS03E-30 LS03E-50	CE205T	13U3642AB17	13.40	12.00	41,000	0.748
CDX1-75N HORIZONTAL	AC14241G2	LS01E-30 LS01E-50	N/A	13C2430HA17	14.00	12.40	24,000	0.733
				13C3036HA17	14.40	12.70	25,400	0.739
	AC14301G2	LS01E-30 LS01E-50	N/A	13C2430HA17	14.00	12.50	29,400	0.739
				13C3036HA17	14.50	13.00	30,400	0.746
	AC14361G2	LS03E-30 LS03E-50	N/A	13C2430HA17	13.70	12.20	34,600	0.740
				13C3036HA17	14.00	12.50	35,600	0.750
	AC14421G2	LS03E-30 LS03E-50	N/A	13C3642HA17	13.40	12.00	41,000	0.748

FURNACE MODEL	CONDENSER MODEL	LINE SET MODEL	COIL CABINET MODEL	EVAPORATOR COIL MODEL	SEER	EER	TOTAL (BTU/HR) HEAT REMOVAL	SENSIBLE HEAT REMOVAL
CDX1-100N COUNTERFLOW	AC14301G2	LS01E-30 LS01E-50	CE107S	13U2430AB15	13.70	12.30	29,000	0.737
			CE206TA	13U3036AB17	14.50	13.00	30,400	0.746
	AC14361G2	LS03E-30 LS03E-50	CE107S	13U2430AB15	13.40	11.95	33,800	0.736
			CE206TA	13U3036AB17	14.00	12.50	35,600	0.750
	AC14421G2	LS03E-30 LS03E-50	CE206TA	13U3642AB17	13.40	12.00	41,000	0.748
	AC14481G2	LS03E-30 LS03E-50	CE206TA	13U3642AB17	13.00	11.60	46,000	0.746
CDX1-100N HORIZONTAL	AC14301G2	LS01E-30 LS01E-50	N/A	13C2430HA21	14.00	12.50	29,400	0.739
				13C3036HA21	14.50	13.00	30,400	0.746
	AC14361G2	LS03E-30 LS03E-50	N/A	13C2430HA21	13.70	12.20	34,600	0.740
				13C3036HA21	14.00	12.50	35,600	0.750
	AC14421G2	LS03E-30 LS03E-50	N/A	13C3642HA21	13.40	12.00	41,000	0.748
				13C4248HA21	13.80	12.20	42,000	0.749
	AC14481G2	LS03E-30 LS03E-50	N/A	13C4860HA26 <sup>2</sup>	14.10	12.50	43,000	0.758
				13C3642HA21	13.00	11.60	46,000	0.746
			13C4248HA21	13.35	12.00	47,500	0.748	
			13C4860HA26 <sup>2</sup>	13.65	12.20	48,500	0.758	

<sup>2</sup> adaption required

SEE NEXT PAGE FOR MORE DATA –

## GAS HIGH-EFFICIENCY COUNTERFLOW / HORIZONTAL FURNACE SPECIFICATIONS

FURNACE MODEL	CONDENSER MODEL	LINE SET MODEL	COIL CABINET MODEL	EVAPORATOR COIL MODEL	SEER	EER	TOTAL (BTU/HR) HEAT REMOVAL	SENSIBLE HEAT REMOVAL
CDX1-125N COUNTERFLOW	AC14361G2	LS03E-30 LS03E-50	CE108S	13U2430AB15	13.40	11.95	33,800	0.736
			CE108S	13U3030AB15	13.70	12.20	34,600	0.740
			CE208TA	13U3036AB17	14.00	12.50	35,600	0.750
	AC14421G2	LS03E-30 LS03E-50	CE208TA	13U3642AB17	13.40	12.00	41,000	0.748
	AC14481G2	LS03E-30 LS03E-50	CE208TA	13U3642AB17	13.00	11.60	46,000	0.746
	AC14601G2	LS03E-30 LS03E-50						
CDX1-125N HORIZONTAL	AC14361G2	LS03E-30 LS03E-50	N/A	13C2430HA23	13.70	12.20	34,600	0.740
				13C3036HA23	14.00	12.50	35,600	0.750
	AC14421G2	LS03E-30 LS03E-50	N/A	13C3642HA23	13.40	12.00	41,000	0.748
				13C4248HA23	13.80	12.20	42,000	0.749
				13C4860HA26 <sup>1</sup>	14.10	12.50	43,000	0.758
	AC14481G2	LS03E-30 LS03E-50	N/A	13C3642HA23	13.00	11.60	46,000	0.746
				13C4248HA23	13.35	12.00	47,500	0.748
				13C4860HA26 <sup>1</sup>	13.65	12.20	48,500	0.758
	AC14601G2	LS03E-30 LS03E-50	N/A	13C4860HA26 <sup>1</sup>	13.00	11.60	60,000	0.753

<sup>1</sup>Needs plenum adapter AOPS7693